



# Two Bottles and a Jar

By Mary L Devendorf

## Fabric Requirements for One Finished 6" x 7" Block

- (1) 1¼" x 7½" Background Fabric
- (1) 2¼" x 1¾" Background Fabric
- (4) 1" x 1" Background Fabric
- (1) 1" x 7½" Background Fabric
- (1) 2" x 2½" Background Fabric
- (1) 2" x 5" Background Fabric

- (1) 2¼" x 5¾" Bottle Fabric #1
- (1) 2¼" x 1" Lid Fabric #1

- (1) 2" x 5" Bottle Fabric #2
- (1) 2" x 1" Lid Fabric #2

- (1) 2" x 2½" Jar Fabric
- (1) 2" x 1" Lid Fabric #3

All seam allowances should be a ¼".  
Make one block for quilt.

1. Draw a diagonal line on back side of (2) 1" Background Squares. Stack on opposite corners of Bottle Fabric #1, right sides together. Stitch on drawn line. Trim excess fabric. Press seams toward triangles.

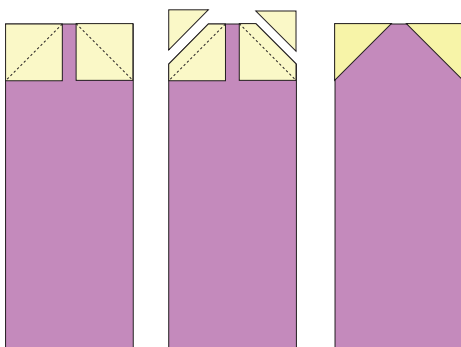

2. Sew a 2¼" x 1" Lid #1 between a 2¼" x 1¾" Background rectangle and Bottle #1 unit. Press seams toward Lid.

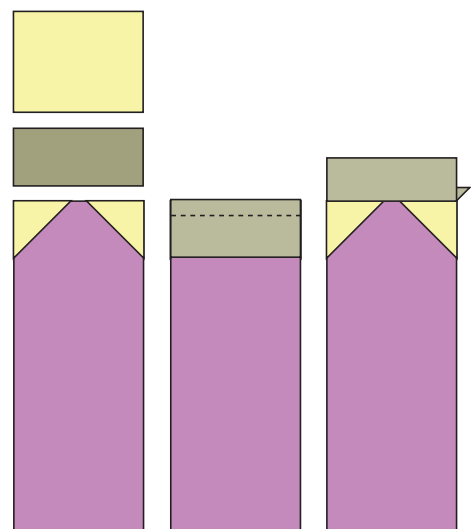

3. Draw a diagonal line on back side of (2) 1" Background Squares. Stack on opposite corners of Bottle Fabric #2, right sides together. Stitch on drawn line. Trim excess fabric. Press seams toward triangles.

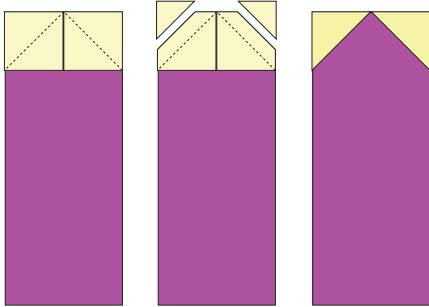

4. Sew a 2" x 1" Lid #2 between a 2" x 2½" Background rectangle and Bottle #2 unit. Press seams toward Lid.

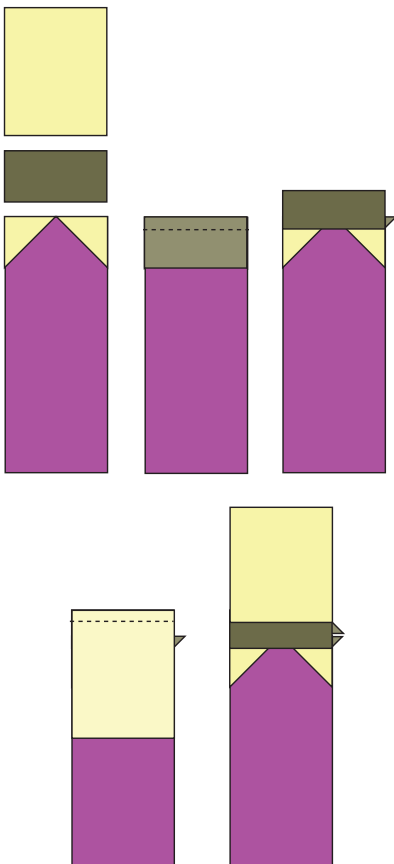

5. Sew a Lid #3 between a 2" x 5" Background rectangle and a 2" x 2½" Jar Fabric. Press seams toward Lid.

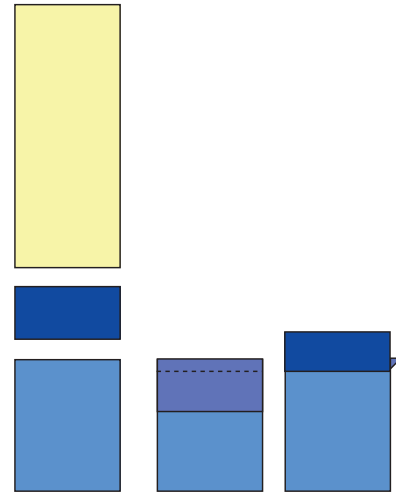

6. Sew a 1¼" x 7½" Background rectangle to left side of Bottle #1. Press seam toward Background.

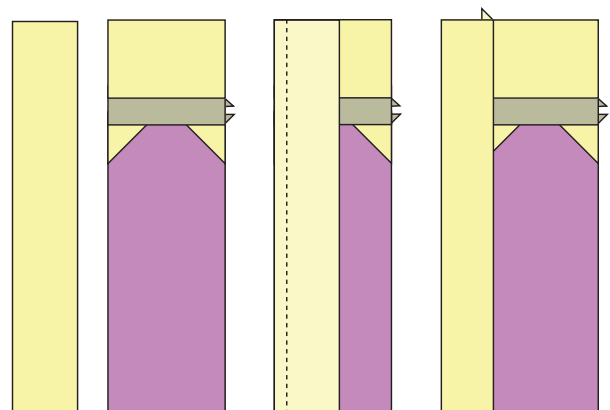

7. Sew a 1" x 7½" Background rectangle to left side of Bottle #2.  
Press seams toward Background.

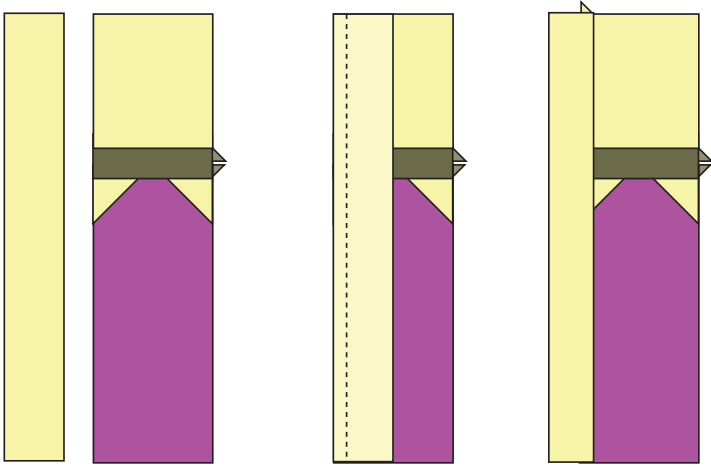

8. Sew the Bottle #2 unit between the Bottle #1 unit and the Jar unit. Press seams as shown.

